

Prezone Map

4-C Ranch Annexation

Existing County Zoning



Proposed City Zoning

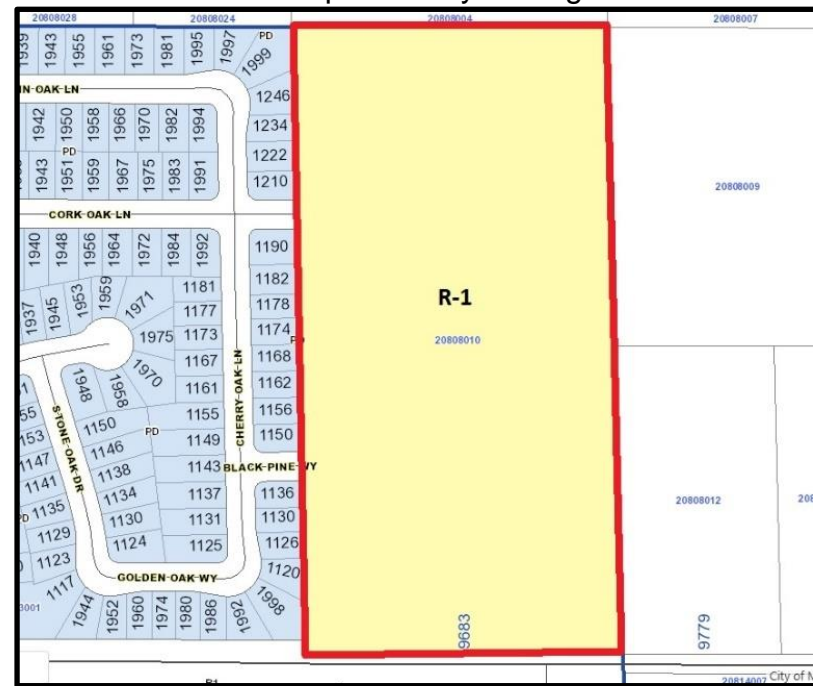

**AU Zone.** The Agriculture-Urban Reserve (AU) Zone is intended to retain in agriculture those areas planned for future urban development in order to facilitate compact, orderly urban development and appropriate timing and economical provision of services and utilities. This zone implements the Agriculture-Urban Reserve land use designation of the General Plan. AU-20 restricts parcels in this district to a minimum of 20 acres in size.

**One-Family Dwelling Zoning District (R-1).** This designation allows for substantial flexibility in selecting dwelling unit types and parcel configurations to suit site conditions and housing needs. The types of dwelling units include small lots and clustered lots as well as conventional large-lot detached residences.