

CITY OF MANTECA
STANDARD SPECIFICATIONS INDEX

<u>DESCRIPTION</u>	<u>PAGE NO.</u>
DEFINITIONS AND TERMS	1
<u>SECTION 10 - DUST CONTROL</u>	
10-1.04 Payment	2
<u>SECTION 15 - EXISTING FACILITIES</u>	
15-1.02 Preservation of Property	3
<u>SECTION 16 - CLEARING AND GRUBBING</u>	
16-1.02 Preservation of Property	4
16-1.03 Construction	4
16-1.04 Removal and Disposal of Materials	5
16-1.06 Payment	5
<u>SECTION 19 - EARTHWORK</u>	
19-1.01 Description	6
19-1.03 Grade Tolerance	6
19-2.02 Unsuitable Material	6
19-2.08 Measurement	6
19-2.09 Payment	6
19-3.06 Structure Backfill	7
19-5.03 Relative Compaction	7
<u>SECTION 26 - AGGREGATE BASES</u>	
26-1.01 Description	8
26-1.035 Adding Water	8
<u>SECTION 39 - ASPHALT CONCRETE</u>	
39-2.01 Asphalt	9
39-2.02 Aggregate	9
39-4.01 Grade Tolerances	10
39-4.02 Prime Coat	10
39-5.01 Spreading Equipment	10
39-5.02 Compacting Equipment	11
39-8.01 Measurement	12
39-9.02 Payment	12
<u>SECTION 63 - CAST-IN-PLACE CONCRETE PIPE</u>	
63 - 1.01 Description	13

DESCRIPTION**PAGE NO.****SECTION 64 – ASBESTOS-CEMENT PIPE**

64-1.01	Description	14
64-1.03	Materials	14
64-1.04	Earthwork	14
64-1.05	Structures	14
64-1.06	Laying Culvert Pipe	15
64-1.08	Payment	15

SECTION 65 - REINFORCED CONCRETE PIPE

65-1.01	Description	16
65-1.04	Earthwork	16
65-1.05	Structures	16
65-1.06	Joints	16
65-1.07	Laying Pipe	17
65-1.10	Payment	17

SECTION 71 - SANITARY SEWER

71-1.02	Materials	18
71-1.02C	Clay Sewer Pipe	18
71-1.02D	Acrylonitrile-Butadiene-Styrene Pipe	18
71-1.02P	Ductile Iron Pipe	19
71-1.02Q	Polyvinyl Chloride Gravity Pipe	20
71-1.03	Excavation and Backfill	23
71-1.04	Existing Manholes	26
71-1.05	Pipe Laying	26
71-1.07	Sewer Structures	28
71-1.08	Testing of Sewers	28
71-1.09	Measurement	29
71-1.10	Payment	30
71-2.01	Large Diameter Polyvinyl Chloride Pipe	30
71-2.02	Materials	30
71-2.03	Joints	31
71-2.04	Fittings	31
71-2.05	Fabrication Requirements	31
71-2.06	Testing & Inspection	31
71-2.07	Special Inspector	32
71-2.08	Installation	32
71-2.09	Certificate of Compliance	32
71-2.10	Pipe Marking	32

SECTION 73 - CONCRETE CURBS AND SIDEWALKS

73-1.01	Description	33
73-1.02	Subgrade Preparation	33
73-1.05	Curb Construction	33
73-1.06	Sidewalk, Gutter Depression, Island Paving and Driveway Construction	33
73-1.08	Measurement	34
73-1.09	Payment	34

DESCRIPTION**PAGE NO.****SECTION 81 – MONUMENTS**

81-1.01 Description	35
---------------------------	----

SECTION 84 - TRAFFIC STRIPES AND PAVEMENT MARKINGS

84-1.01 Description	36
84-1.02 Control of Alignment and Layout	36
84-1.04 Protection from Damage	36
84-1.05 Application	36
84-1.06 Measurement	37
84-1.07 Payment	37

SECTION 85 - PAVEMENT MARKERS

85-1.01 Description	38
85-1.06 Placement.....	38
85-1.08 Measurement	39
85-1.09 Payment	39

SECTION 86 - SIGNALS, ~~AND LIGHTING~~, AND, FIBER OPTIC CONDUIT

86-1.01 Description	40
86-1.03 Equipment List and Drawings	40
86-2.01 Excavation and Backfill	40
86-2.03 Foundations	41
86-2.04 Standard Steel Pedestals and Posts	41
86-2.05 Conduit	41
86-2.06 Pull Boxes	42
86-2.08 Conductors	42
86-2.09 Cable Pulling and Splicing	43
86-2.10 Bonding and Grounding	43
86-2.11 Service Connection	43
86-6.07 Photoelectric Controls	43

86-7.01 Fiber Optic Conduit**SECTION 99 - WATER MAIN CONSTRUCTION**

99-1.01 Description	44
99-1.02 Pipe	44
99-1.03 Joints	45
99-1.04 Ductile Iron Fittings	45
99-1.05 Cast Iron Fittings	45
99-1.06 Fittings for Polyvinyl Chloride Pipe (PVC)	45
99-1.07 Resilient Seat Gate Valves	46
99-1.08 Rubber Seated Butterfly Valves	46
99-1.09 Valve Boxes	46
99-1.10 Appurtenances	46
99-1.11 Laying and Handling Pipe Material	47
99-1.12 Thrust Blocking	48
99-1.13 Connections to Existing Water Mains	48
99-1.14 Hydrostatic Test	48
99-1.15 Disinfecting Water Mains	49
99-1.16 Measurement	50
99-1.17 Payment	50
99-2.00 Large Diameter Polyvinyl Chloride Water Pipe.....	51

86-7.0 FIBER OPTIC CONDUIT

The Contractor shall furnish and install material and equipment necessary to install conduit for fiber optic cable.

Conduit shall be type 40-4" PVC conduit and shall meet all criteria as noted in section 86-7.05 Conduit. All boxes and vault types for fiber optic conduit shall be light duty or traffic rated, depending on placement, and as follows:

- a) Node Vault 3" (W) x 5' (L) x 4' - 6" (D)
- b) Fiber Vault 30" (W) x 48" (L) x 34" (D)
- c) Service Vault 24" (W) x 36" (L) x 34" (D)

N40

CHRISTY®

COVER

Style:	Flush
Material:	Reinforced Concrete
Model:	24" x 36"
Weight:	196 lbs
Options:	Special Markings
Surface:	Skid Resistant & Marked*
Coefficient of Friction:	>0.6 ASTM 1028
Performance:	ASTM C 857, WUC 3.6

Cover comes standard with permanent markings for manufacturer, load rating, model size and manufacturing location.

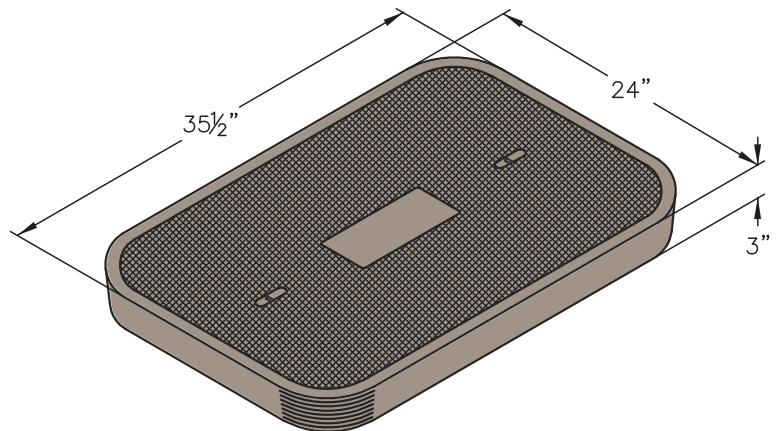

BODY

Material:	Reinforced Concrete with Composite Cap
Model:	22" x 35"
Weight:	172 lbs
Wall Type:	Straight
Mouseholes:	0 - 2
Performance:	ASTM C 857, WUC 3.6

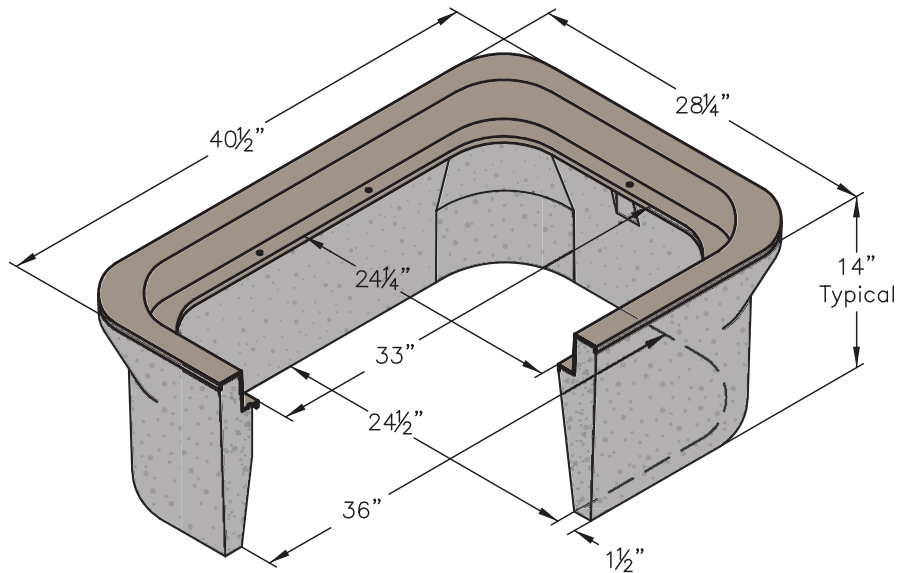

EXTENSION

Material:	Reinforced Concrete
Depth:	12"
Weight:	189 lbs

LOAD RATING / NOTES



LIGHT DUTY
PEDESTRIAN / GREENBELT

For use in non-vehicular traffic situations only. Weights and dimensions may vary slightly. Actual load rating is determined by the box and cover combination.

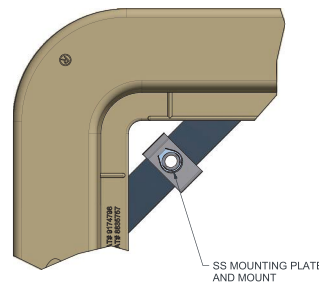

Bolt Down Detail

N40

CHRISTY®

COVER OPTIONS

R-Series, Flush Solid
Steel Checker Plate, Solid

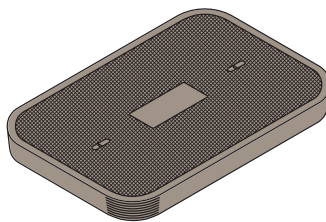

R-Series
Flush Solid

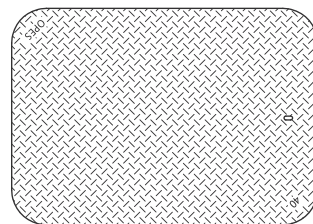

Steel Checker Plate

COVER OPTIONS

Bolt Down Locking (R-Series Covers)
Galvanizing (Steel Covers)
EMS Marker

 **WARNING:** Cancer and Reproductive Harm - www.P65Warnings.ca.gov

All information contained on this sheet is current at the time of publication.
Oldcastle reserves the right to discontinue or update product information without notice.

Revision 12/06/18
© 2018 Oldcastle Infrastructure

N48

CHRISTY®

COVER

Style:	Flush (2 Piece)
Material:	Reinforced Concrete
Model:	30" x 48"
Weight:	396 lbs
Options:	Special Markings
Surface:	Skid Resistant & Marked*
Coefficient of Friction:	>0.6 ASTM 1028
Performance:	ASTM C 857, WUC 3.6

Cover comes standard with permanent markings for manufacturer, load rating, model size and manufacturing location.

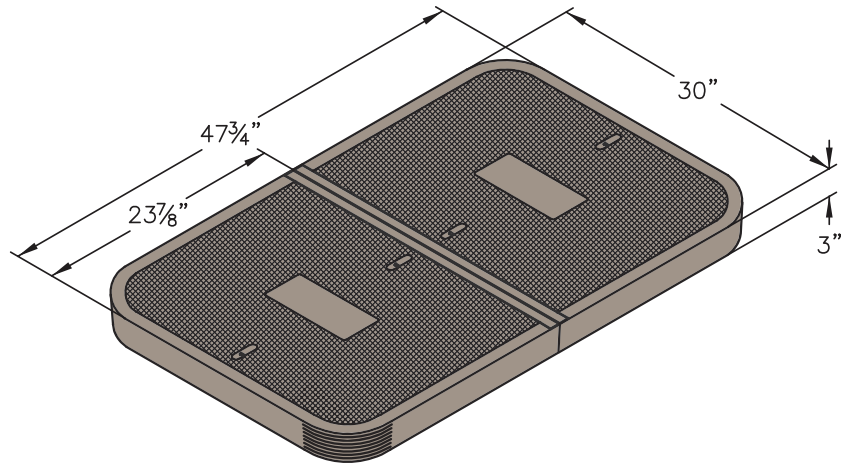

BODY

Material:	Reinforced Concrete with Composite Cap
Model:	30" x 48"
Weight:	376 lbs
Wall Type:	Straight
Mouseholes:	0
Performance:	ASTM C 857, WUC 3.6

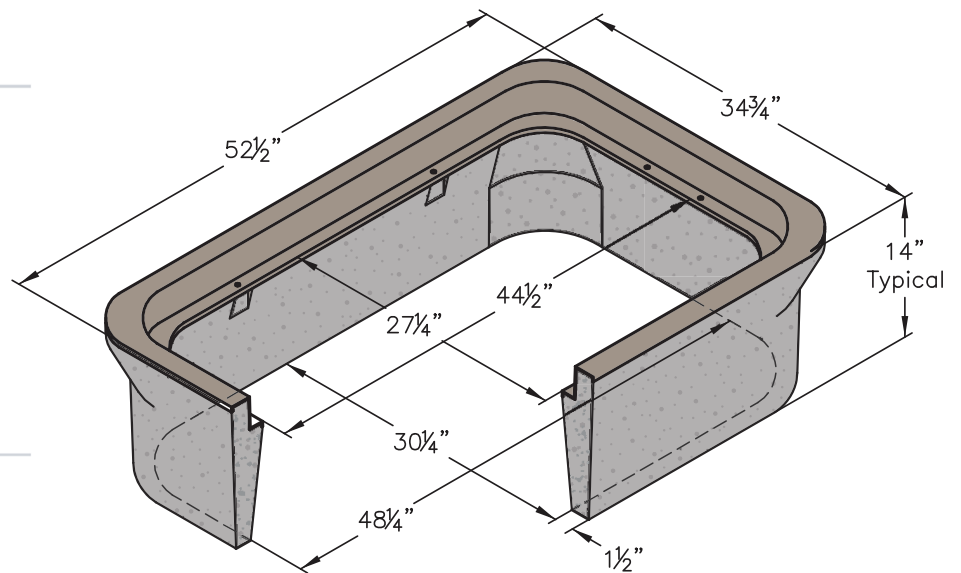

EXTENSION

Material:	Reinforced Concrete
Depth:	10"
Weight:	288 lbs

LOAD RATING / NOTES



LIGHT DUTY
PEDESTRIAN / GREENBELT

For use in non-vehicular traffic situations only. Weights and dimensions may vary slightly. Actual load rating is determined by the box and cover combination.

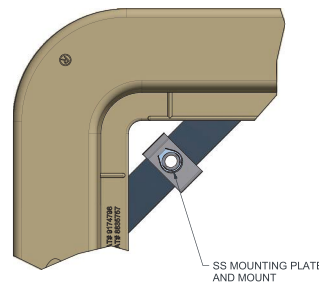

Bolt Down Detail

N48

CHRISTY®

COVER OPTIONS

R-Series, Flush Solid (2 Piece)
Steel Checker Plate, Solid (2 Piece)

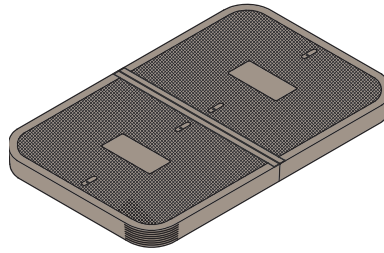

R-Series

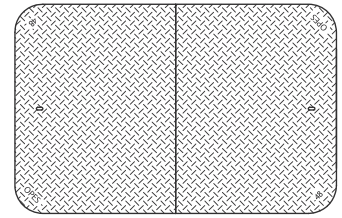

Steel Checker Plate

COVER OPTIONS

Bolt Down Locking (R-Series Covers)
Galvanizing (Steel Covers)
EMS Marker

 **WARNING:** Cancer and Reproductive Harm - www.P65Warnings.ca.gov

All information contained on this sheet is current at the time of publication.
Oldcastle reserves the right to discontinue or update product information without notice.

Revision 12/06/18
© 2018 Oldcastle Infrastructure

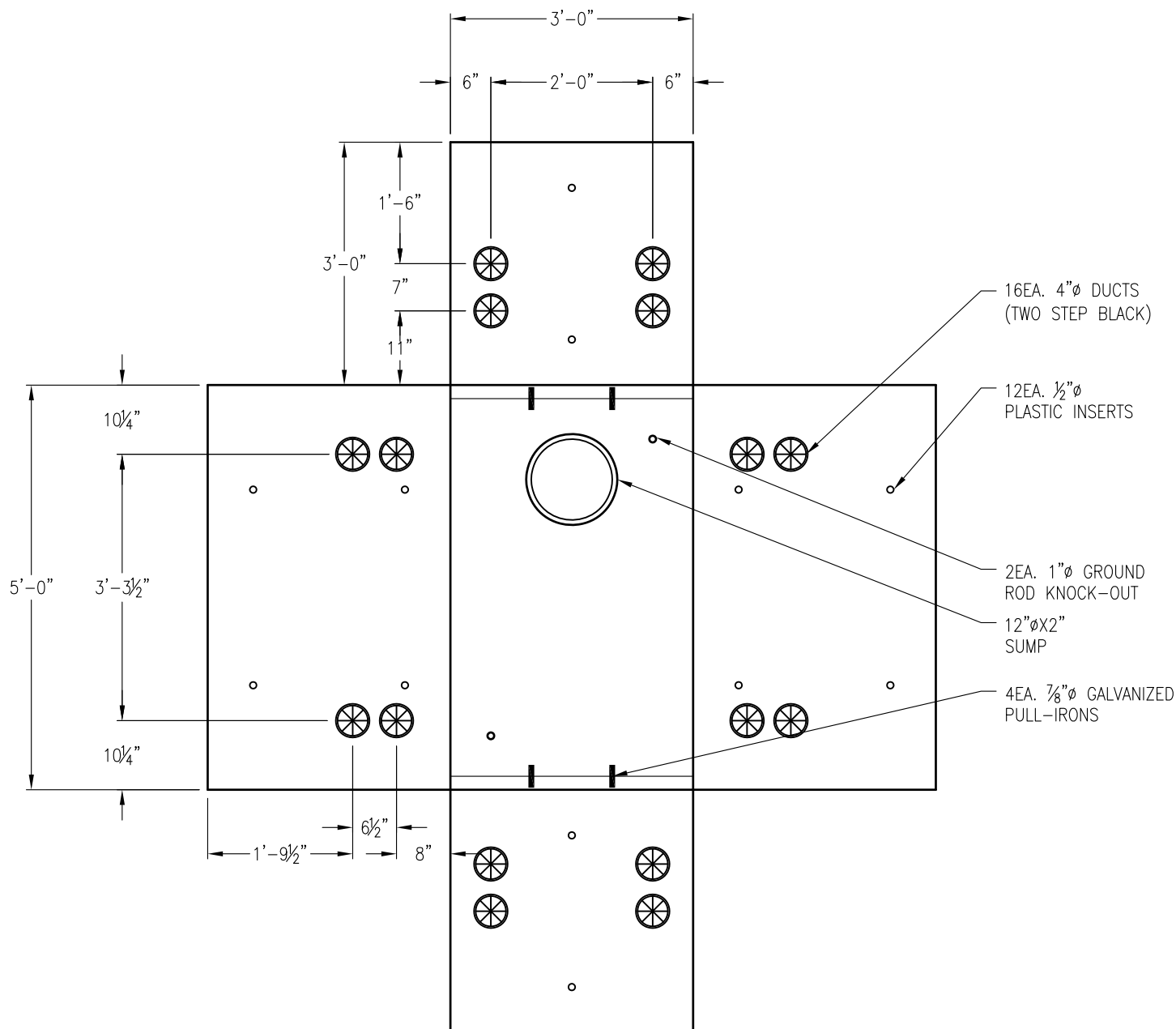

DRAWING MAY NOT CONFORM TO THE
MOST CURRENT SPECIFICATION



Northern California
Madera ■ Morgan Hill ■ Pleasanton ■ Santa Rosa ■ Stockton ■ Tulare
Phone: 925-750-6650 Fax: 925-750-6660

AT&T-3660-3

FILE NAME: ATT-3.DWG

REVISED: MARCH 2016

www.oldcastleprecast.com

3'-0" X 5'-0" X 3'-0" (I.D.)
SUB-SURFACE ENCLOSURE
AT&T

Copyright © 2017 Oldcastle Precast, Inc.

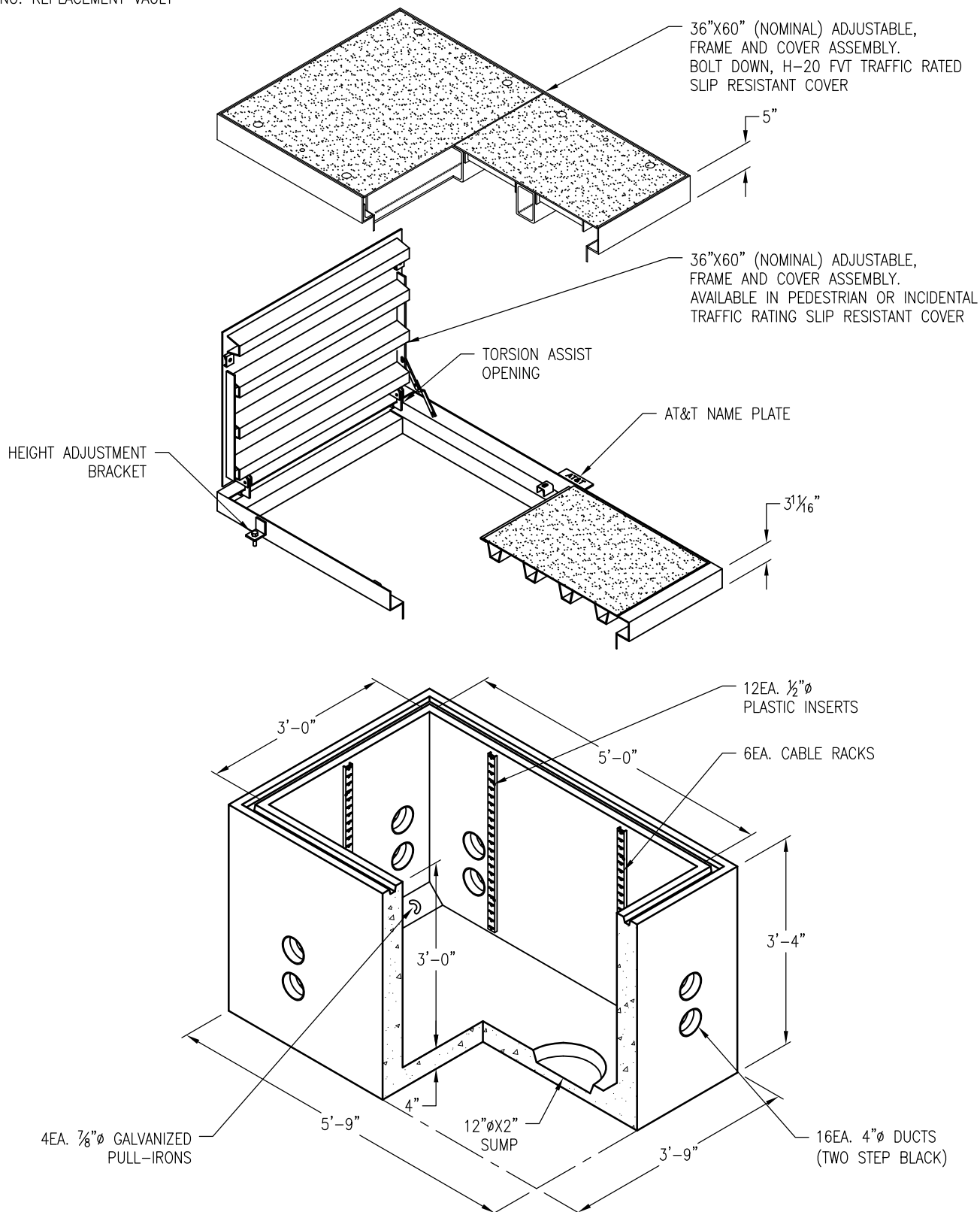

VAULT WEIGHT: 4,140 LBS.

DRAWING MAY NOT CONFORM TO THE
MOST CURRENT SPECIFICATION



Oldcastle Precast®

Northern California
Madera ■ Morgan Hill ■ Pleasanton ■ Santa Rosa ■ Stockton ■ Tulare
Phone: 925-750-6650 Fax: 925-750-6660

AT&T-3660-3

FILE NAME: ATT-3.DWG

REVISED: MARCH 2016

www.oldcastleprecast.com

**3'-0" X 5'-0" X 3'-0" (I.D.)
SUB-SURFACE ENCLOSURE
AT&T**

Copyright © 2016 **Oldcastle Precast, Inc.**

APPROVED MATERIALS FOR PIPES

SANITARY SEWER LINES

- 1) Vitrified Clay Pipe (Extra Strength)
- 2) Ductile Iron Cement Lined, Class 50
- 3) Polyvinyl Chloride Gravity Pipe (P.V.C.), SDR-35
- 4) Acrylonitrile-Butadiene-Styrene Pipe (A.B.S.), SDR-23.5

WATER LINES

- 1) Asbestos-Cement Pipe, Class 150
- 2) Ductile Iron Pipe (D.I.P.), Class 150, Cement lined inside
- 3) Polyvinyl Chloride Pressure Pipe (P.V.C.), Class 150 DR 18, **AWWA (C-900)**
- 4) Polyvinyl Chloride Pipe (P.V.C.), Schedule 40 (for irrigation treewells only)

STORM DRAIN LINES

- 1) Reinforced Concrete Pipe, Class III (minimum)
- 2) Asbestos-Cement Pipe, Class III (minimum)
- 3) Polyvinyl Chloride Gravity Pipe (P.V.C.), SDR-35

FIBER OPTIC CONDUIT

- 1) Polyvinyl Chloride Pipe (P.V.C), Schedule 40

NOTES:

1. REFER TO THE APPROPRIATE SECTION OF THE STANDARD SPECIFICATIONS FOR APPROVED PIPE CLASSIFICATIONS.
2. ALL MATERIALS TO BE APPROVED BY THE PUBLIC WORKS DEPARTMENT.

NO.	HYISID	BY	PIPE MATERIALS	APPROVED BY: r
				◆ K S
DRAWN n, J. KOESTER			CITY OF MANTECA DEPARTMENT OF PUBLIC WORKS	DRAWING NO. U-1
CHICKID rt: J. PODESTA				DATE: JAN. 19881
SCALE: NONE				

INSTALLATION SPECIFICATIONS FOR LARGE DIAMETER SEWER AND STORM DRAIN PIPE

GENERAL

The requirements of this specification apply to the following:

1. All "Large Diameter" sanitary sewer pipe 18" in diameter or greater;
2. All "Large Diameter" storm drain pipe, 18" in diameter or greater.

The requirements of this section do not apply to High Density Polyethylene "HDPE" storm drain pipe. (Refer to Standard U-2B)

MATERIALS

"Large Diameter" pipe materials shall comply with City of Manteca Standard Plans and Specifications.

TESTING AND INSPECTION

Testing and inspection shall be in accordance with City of Manteca Standard Plans and Specifications.

All "Large Diameter" sewer and storm drain pipe, except Reinforced Concrete Pipe, installed in the City of Manteca, shall be inspected by means of a closed-circuit color television camera at the expense of the Contractor. The City shall be provided with one reproducible (VHS) format copy of the video inspection. The quality of the picture shall be acceptable to the City, if unacceptable, the pipe shall be retelevised. The City shall also be provided with a copy of the television inspection log.

SPECIAL INSPECTOR

A Special Inspector shall be present during the installation of all "Large Diameter" sewer and storm drain pipe, except Reinforced Concrete Pipe.

The Public Works Department shall approve the resume of the Special Inspector. The Special Inspector shall submit a signed daily report to the Public Works Department at the end of each workday. The Contractor shall be responsible for paying the cost of providing a Special Inspector.

MINIMUM COVER REQUIREMENTS

All sewer and storm drain pipe, regardless of size, installed in the traveled way shall have a minimum of thirty inches (30") of cover measured from the top of the pipe to finished grade. If the cover is less than thirty inches (30"), to an absolute minimum cover of eighteen inches (18"), cement lined Ductile Iron Pipe shall be used.

Any sewer or storm drain pipe installed in the traveled way with less than eighteen inches (18") of cover shall be rejected.

NO.	REVISED	BY	LARGE DIAMETER SEWER AND STORM DRAIN PIPE	APPROVED BY:
2	9/30/02	JP		<i>Michael F. Brinton</i> DIRECTOR OF PUBLIC WORKS
DRAWN BY: S. FOX			CITY OF MANTECA DEPARTMENT OF PUBLIC WORKS	DRAWING NO. U-2A
CHECKED BY: J. PODESTA				DATE: JAN. 1988
SCALE: NONE				

**INSTALLATION SPECIFICATIONS FOR HIGH DENSITY
POLYETHYLENE STORM DRAIN PIPE TEN INCHES (10") TO
TWENTY-FOUR INCHES (24") IN DIAMETER**

GENERAL

The requirements of this specification apply to ten inch (10") to twenty-four inch (24") corrugated, smooth interior, High Density Polyethylene "HDPE" storm drain pipe with water tight joints.

MATERIALS

Pipe shall conform to the latest edition of AASHTO M294 "Type S". Joints shall be watertight attained by using rubber gasketed bell and spigot joints or sanitary fittings with O-ring seals. All fittings, end caps and repair materials shall be supplied or recommended by the manufacturer.

INSTALLATION

Installation shall be in conformance with the latest edition of ASTM D 2321.

SUBMITTALS

Contractor shall submit the following for review and approval by the Public Works Department (Allow 2-weeks for review):

1. Manufacturer's literature on pipe and fittings. Include manufacturer's installation recommendations.
2. Engineer's Report, stamped and signed by a registered Civil Engineer. The report, which shall reference and be in accordance with ASTM D 2321 (Latest Edition), shall provide the following information:
 - a. Soil boring logs, for borings to a depth of five feet (5') below the trench foundation or to groundwater (whichever is deeper), showing depth to groundwater, soil classification and description. The location of the borings shall be along the pipe alignment and shall be sufficient in number to ensure sub surface conditions have been adequately identified the entire length of pipe to be installed.
 - b. A map showing the location of the borings with respect to the pipe alignment.
 - c. Buoyancy calculations showing minimum depth of cover required to prevent the pipe from floating.
 - d. A trench cross section showing trench width and depth, and recommended foundation, embedment and backfill materials. Include embedment compaction requirements.

TESTING AND INSPECTION

Testing and inspection shall be in accordance with City of Manteca Standard Plans and Specifications.

Page 1 of 2

NO.	REVISED	BY	HIGH DENSITY POLYETHYLENE (HDPE) STORM DRAIN PIPE	APPROVED BY:	 DIRECTOR OF PUBLIC WORKS
DRAWN BY: S. FOX			CITY OF MANTECA DEPARTMENT OF PUBLIC WORKS	DRAWING NO.	U-2B
CHECKED BY: J. PODESTA				DATE: OCT. 2002	
SCALE: NONE					

"HDPE" storm drain pipe, installed in the City of Manteca, shall be inspected by means of a closed-circuit color television camera at the expense of the Contractor. The City shall be provided with one reproducible (VHS) format copy of the video inspection. The quality of the picture shall be acceptable to the City, if unacceptable, the pipe shall be retelevised. The City shall also be provided with a copy of the television inspection log.

"HDPE" storm drain pipe shall be mandrel tested prior to acceptance. The maximum allowable deflection shall be 7 ½ % of the base diameter.

At the end of one-year, prior to the exoneration of the warranty bond for construction of public improvements, "HDPE" storm drain pipe shall be mandrel tested a second time. The maximum allowable deflection shall be 7 ½ % of the base diameter.

Mandrel testing shall be done at the expense of the Contractor.

SPECIAL INSPECTOR

A Special Inspector shall be present during the installation of "HDPE" storm drain pipe. The Public Works Department shall approve the resume of the Special Inspector. The Special Inspector shall submit a signed daily report to the Public Works Department at the end of each workday. The Contractor shall be responsible for paying the cost of providing a Special Inspector.

MINIMUM COVER REQUIREMENTS

"HDPE" storm drain pipe shall have a minimum of thirty-six inches (36") of cover measured from the top of the pipe to finished grade. If the cover is less than thirty-six inches (36"), to an absolute minimum cover of eighteen inches (18"), cement lined Ductile Iron Pipe shall be used.

Any "HDPE" pipe installed in the traveled way with less than eighteen inches (18") of cover shall be rejected.

Page 2 of 2

NO.	REVISED	BY	HIGH DENSITY POLYETHYLENE (HDPE) STORM DRAIN PIPE	APPROVED BY:	 DIRECTOR OF PUBLIC WORKS
DRAWN BY: S. FOX			CITY OF MANTECA DEPARTMENT OF PUBLIC WORKS	DRAWING NO.	U-2B
CHECKED BY: J. PODESTA				DATE: OCT. 2002	
SCALE: NONE					

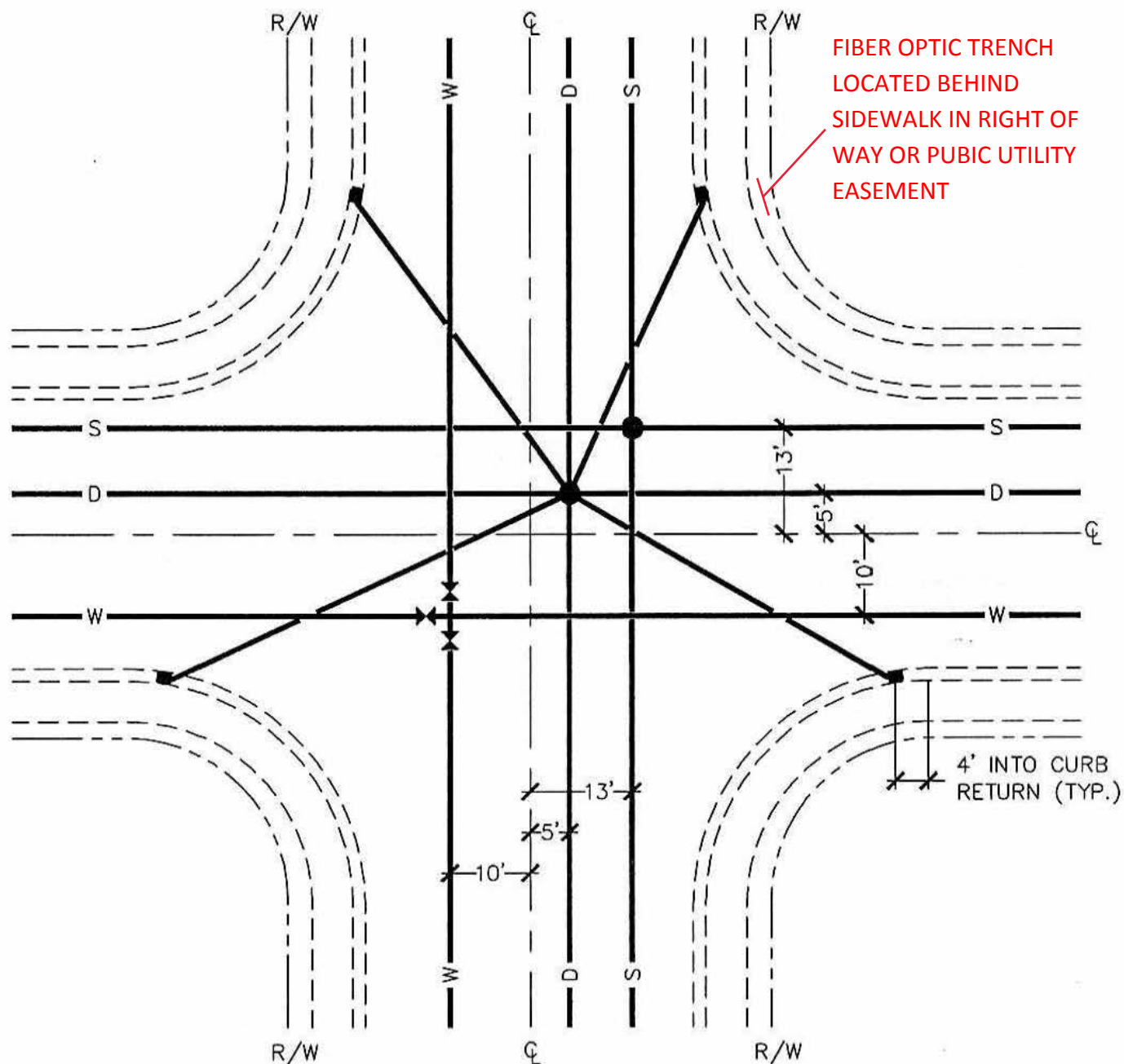

LEGEND:

— D —	STORM DRAIN	— X —	WATER VALVE
— S —	SANITARY SEWER	— / —	CURB INLET
— W —	WATER LINE	— — —	CENTERLINE
●	MANHOLE	— — —	RIGHT-OF-WAY LINE

NO.	REVISED	BY
1	JUN. 1999	JH
DRAWN BY: J. HULSEY		
CHECKED BY: J. PODESTA		
SCALE: NONE		

**LOCATION OF
CITY UTILITIES**
CITY OF MANTECA
DEPARTMENT OF PUBLIC WORKS

APPROVED BY:	
DIRECTOR OF PUBLIC WORKS	
DRAWING NO.	U-3
DATE: JAN. 1988	

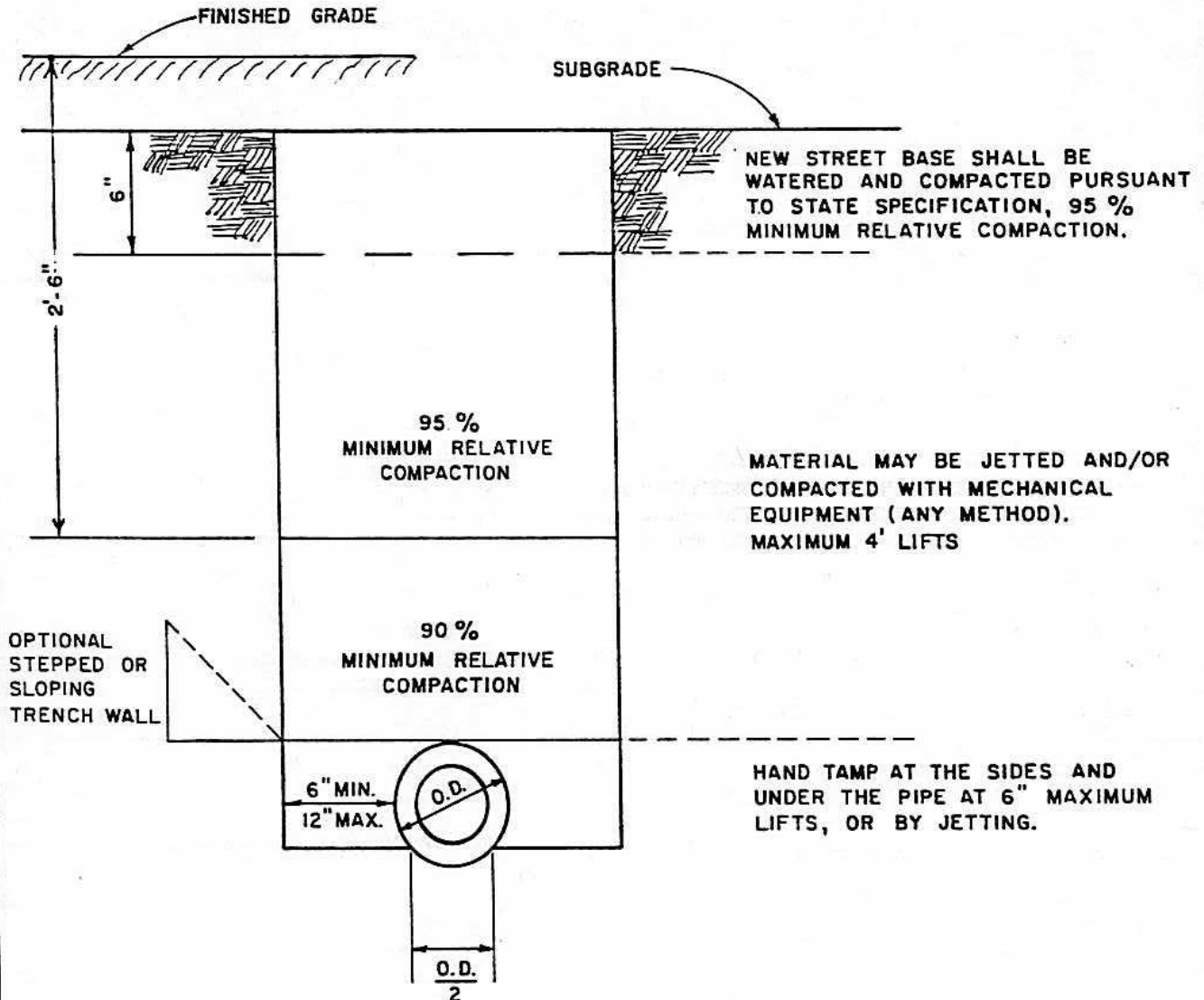

NOTES:

1. ANY AREA AT THE BOTTOM OF THE TRENCH DETERMINED TO BE UNSUITABLE BY THE ENGINEER SHALL BE REMOVED AND REPLACED WITH DRAIN ROCK (1-1/2" X 3/4" OR 2-1/2" X 1-1/2").
2. SELECTED NATIVE MATERIAL MAY BE USED IN ALL TRENCH BACKFILL ZONES AND SHALL BE FREE OF ORGANIC MATERIAL, STONES, OR LUMPS EXCEEDING 3" IN GREATEST DIMENSION.
3. COMPACTION TESTING SHALL BE REQUIRED AS DIRECTED BY THE CITY ENGINEER.

NO.	REVISED	BY	TRENCH BACKFILL FOR NEW SUBDIVISION STREET	APPROVED BY:	<i>M. Brinton</i> DIRECTOR OF PUBLIC WORKS
DRAWN BY: J. KOESTER			CITY OF MANTECA DEPARTMENT OF PUBLIC WORKS	DRAWING NO.	U-4
CHECKED BY: J. PODESTA				DATE: JAN. 1988	
SCALE: NONE					

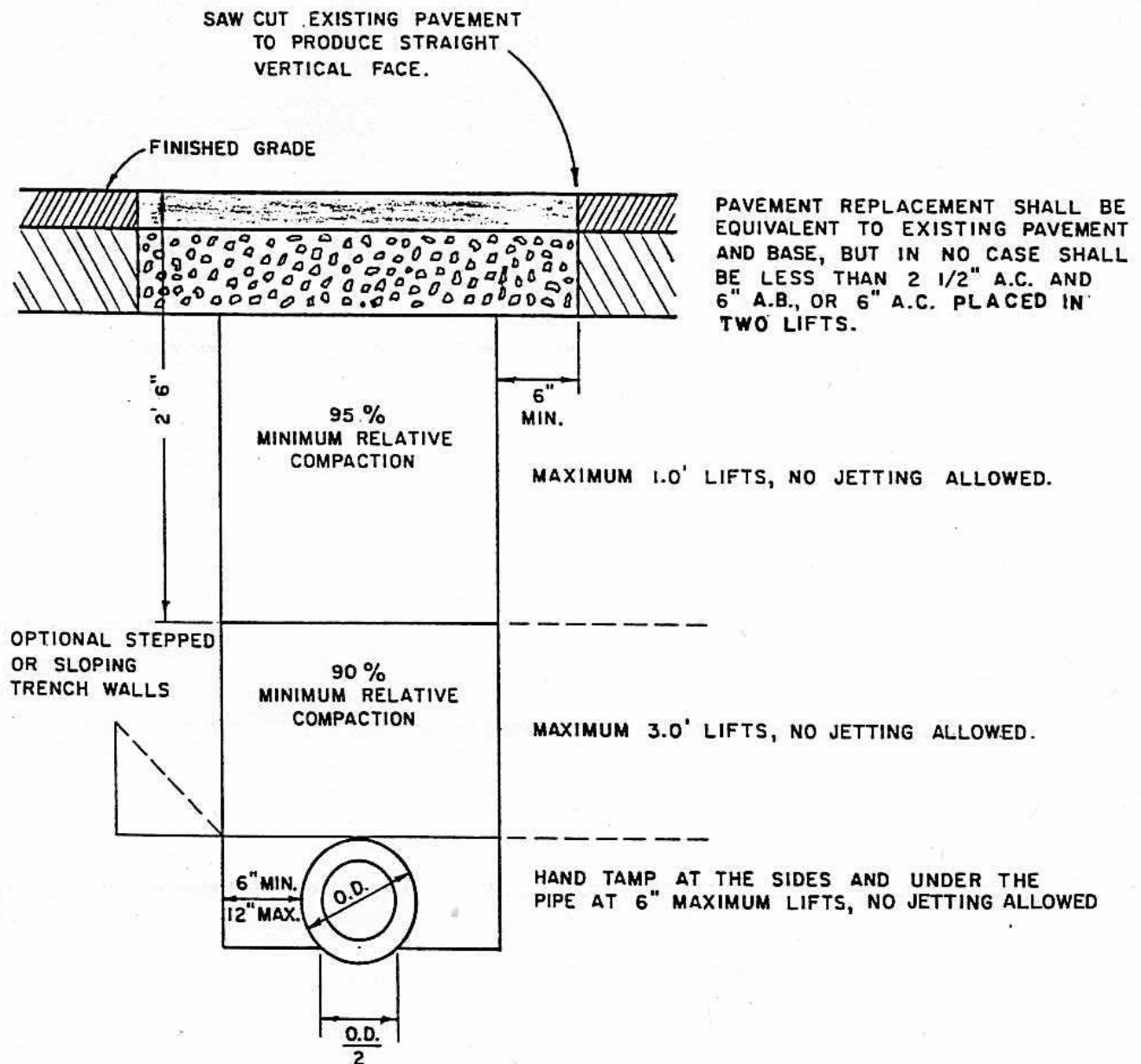

NOTES:

1. ANY AREA AT THE BOTTOM OF THE TRENCH DETERMINED TO BE UNSUITABLE BY THE ENGINEER SHALL BE REMOVED AND REPLACED WITH DRAIN ROCK (1-1/2" X 3/4" OR 2-1/2" X 1-1/2").
2. SELECTED NATIVE MATERIAL MAY BE USED IN ALL TRENCH BACKFILL ZONES AND SHALL BE FREE OF ORGANIC MATERIAL, STONES, OR LUMPS EXCEEDING 3" IN GREATEST DIMENSION.
3. COMPACTION TESTING SHALL BE REQUIRED AS DIRECTED BY THE CITY ENGINEER.

NO.	REVISED	BY	TRENCH BACKFILL IN EXISTING STREETS CITY OF MANTECA DEPARTMENT OF PUBLIC WORKS	APPROVED BY:  DIRECTOR OF PUBLIC WORKS
DRAWN BY: A. MENOR				DRAWING NO. U-5
CHECKED BY: J. PODESTA				DATE: JAN. 1988
SCALE: NONE				

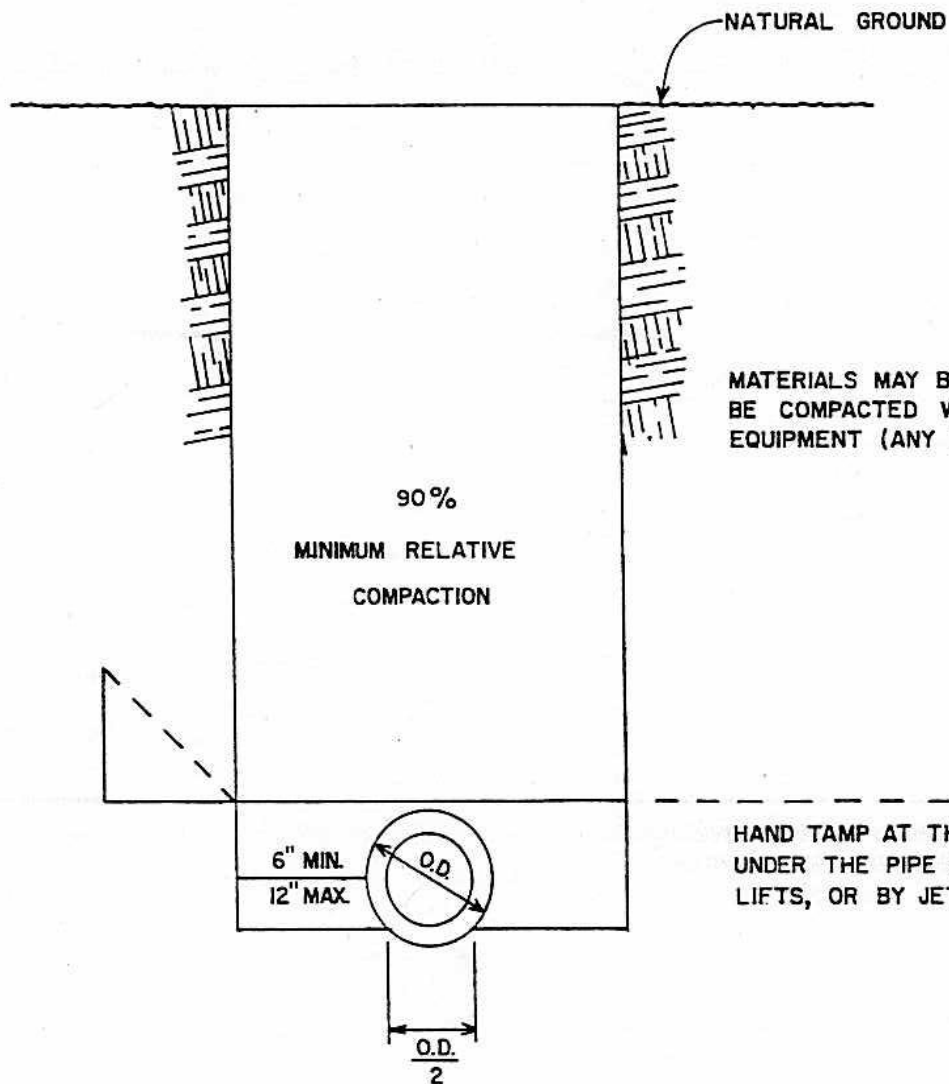

MATERIALS MAY BE JETTED AND
BE COMPACTED WITH MECHANICAL
EQUIPMENT (ANY METHOD).

HAND TAMP AT THE SIDES AND
UNDER THE PIPE AT 6" MAXIMUM
LIFTS, OR BY JETTING.

NO.	REVISED	BY	TRENCH BACKFILL OUTSIDE STREET AREAS (P.U.E.)	APPROVED BY:
				<i>m. Brinton</i>
DRAWN BY: A. MENOR				DIRECTOR OF PUBLIC WORKS
CHECKED BY: J. PODESTA				DRAWING NO.
SCALE: NONE			CITY OF MANTECA DEPARTMENT OF PUBLIC WORKS	DATE: JAN. 1988

U-6

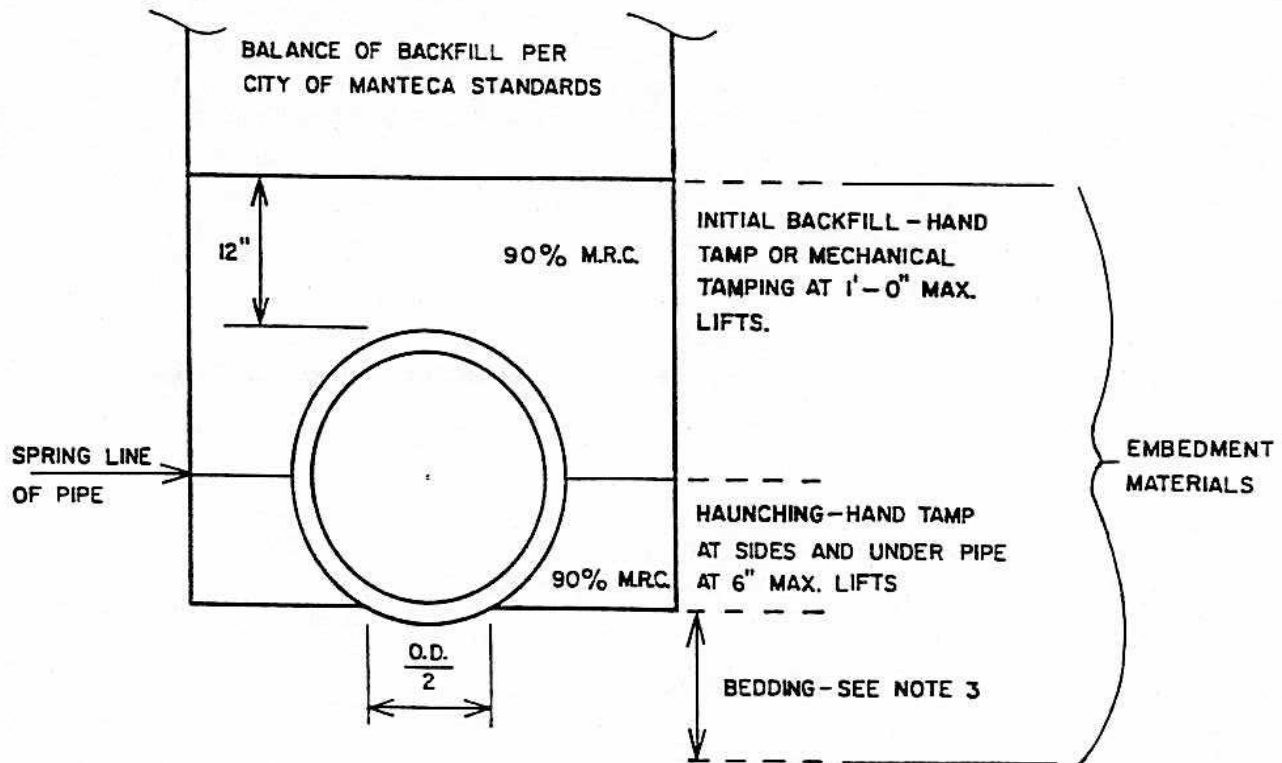

NOTES:

1. ALL EMBEDMENT MATERIALS SHALL CONFORM TO CLASS I, II, OR III SOIL CLASSIFICATIONS AS DESIGNATED IN ASTM D-2321.
2. SELECTED NATIVE MATERIALS CONFORMING TO CLASS I, II, OR III MAY BE USED IN ALL EMBEDMENT MATERIAL ZONES. NATIVE MATERIAL SHALL BE FREE OF ORGANIC MATERIAL, STONES OR LUMPS EXCEEDING 3" IN GREATEST DIMENSION.
3. ANY AREA AT THE BOTTOM OF THE TRENCH DETERMINED TO BE UNSUITABLE BY THE ENGINEER SHALL BE REMOVED AND REPLACED WITH 6" OF CLASS I, II, OR III MATERIALS AT 95% MINIMUM RELATIVE COMPACTION. IN A CASE WHERE THE TRENCH BOTTOM IS UNSTABLE, THE BOTTOM AREA SHALL BE REMOVED AND REPLACED WITH CLASS I OR CLASS II MATERIALS TO A DEPTH DETERMINED BY THE ENGINEER.
4. JETTING WILL NOT BE ALLOWED IN THE EMBEDMENT ZONES. COMPACTION OF EMBEDMENT MATERIALS SHALL CONSIST OF HAND TAMPING AND/OR MECHANICAL TAMPING.

NO.	REVISED	BY	TRENCH BACKFILL FOR P.V.C. PIPE CITY OF MANTECA DEPARTMENT OF PUBLIC WORKS	APPROVED BY:	 DIRECTOR OF PUBLIC WORKS
DRAWN BY: C. SABERTON					
CHECKED BY: J. PODESTA				DRAWING NO.	
SCALE: NONE				DATE: JAN. 1988	

U-7

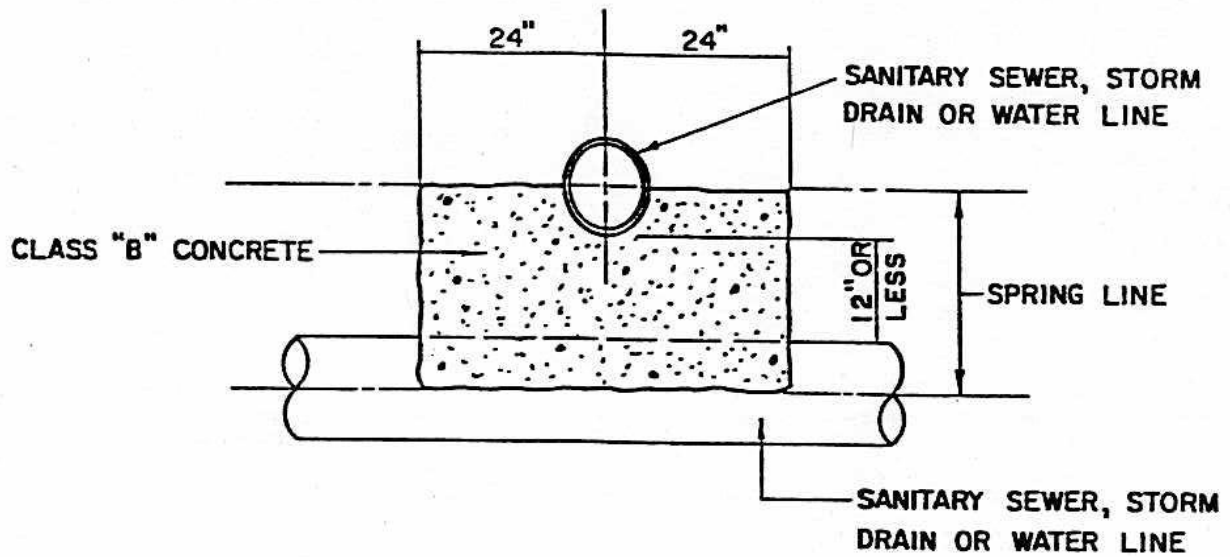

SIDE VIEW

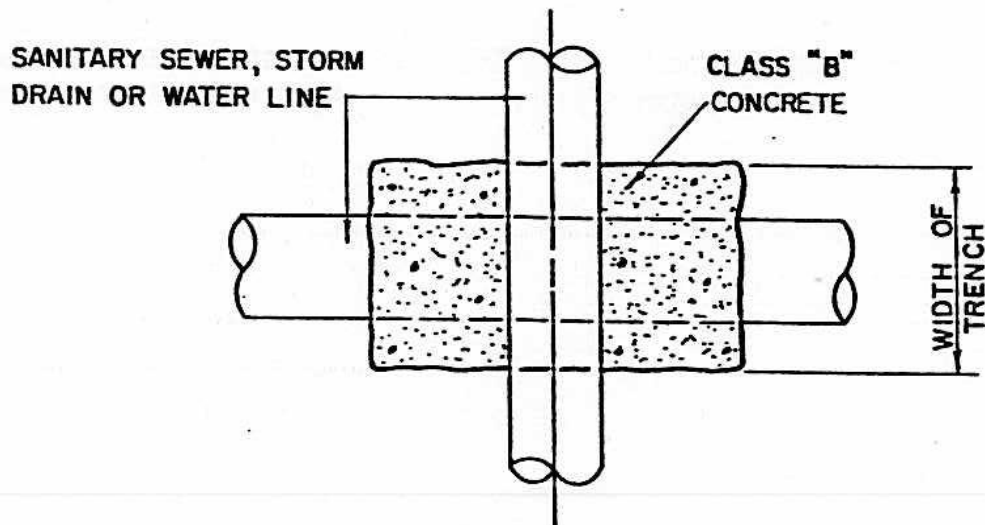

PLAN VIEW

NOTES:

1. APPLICABLE IN CASES WHERE CLEARANCE IS 12 INCHES OR LESS.

NO.	REVISED	BY	UNDERGROUND UTILITY CROSSING CITY OF MANTECA DEPARTMENT OF PUBLIC WORKS	APPROVED BY:	 DIRECTOR OF PUBLIC WORKS	
DRAWN BY: J. KOESTER				DRAWING NO.		U-8
CHECKED BY: J. PODESTA				DATE: JAN 1988		
SCALE: NONE						

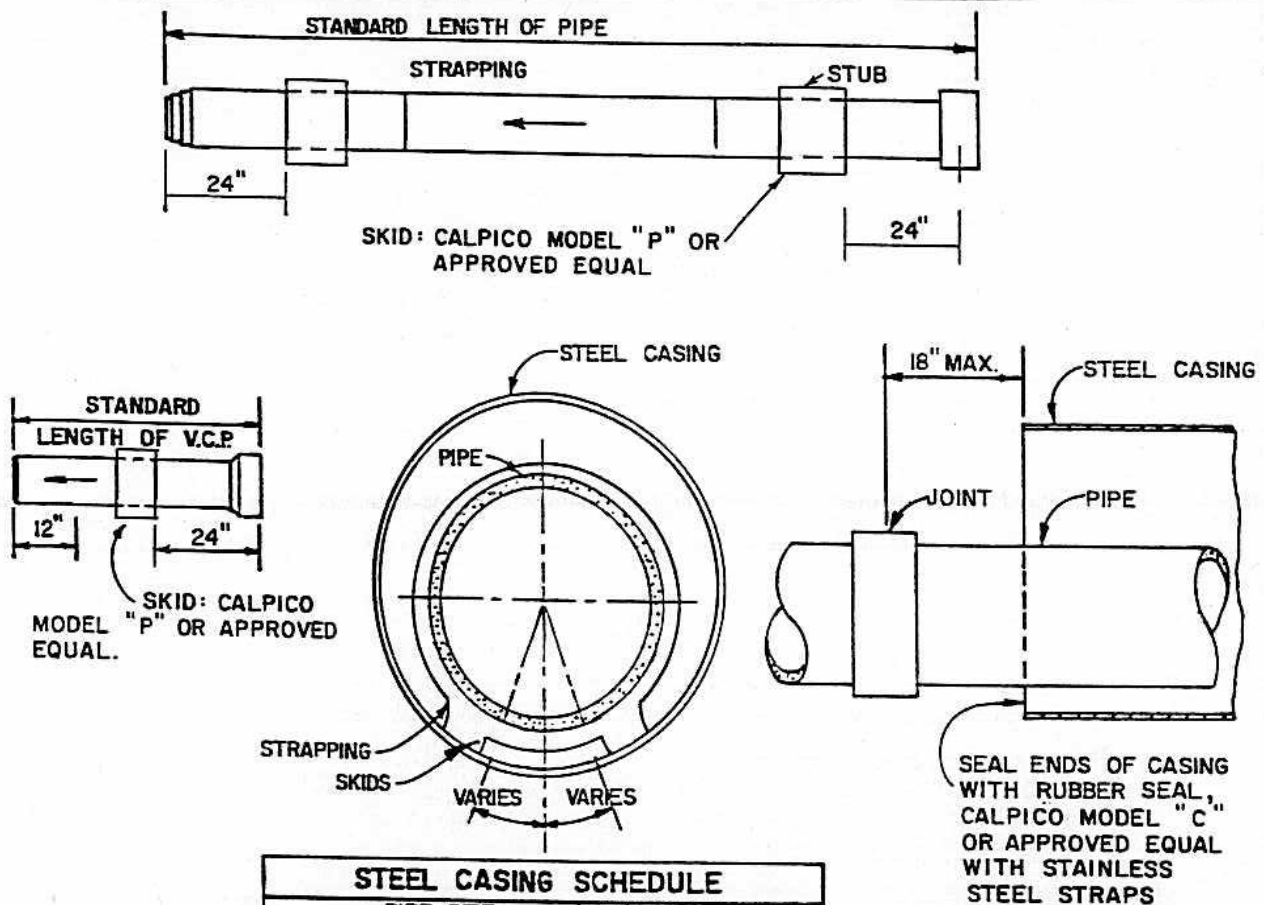

STEEL CASING SCHEDULE		
PIPE SIZE	CASING	THICK.
6" ASBESTOS CEMENT	12" I.D.	3/16"
8" ASBESTOS CEMENT	16" I.D.	1/4"
10" ASBESTOS CEMENT	18" I.D.	1/4"
12" ASBESTOS CEMENT	20" I.D.	1/4"
16" ASBESTOS CEMENT	30" I.D.	11/32"
6" VITRIFIED CLAY	14" I.D.	3/16"
8" VITRIFIED CLAY	16" I.D.	1/4"
10" VITRIFIED CLAY	20" I.D.	1/4"
12" VITRIFIED CLAY	22" I.D.	1/4"
15" VITRIFIED CLAY	30" I.D.	11/32"
18" VITRIFIED CLAY	30" I.D.	11/32"

NOTES:

1. CASING SHALL BE INSTALLED BY THE JACKING OR BORING METHOD.
2. CASING JOINTS SHALL BE WELDED OR RIVETED TYPE.
3. SKIDS SHALL BE PROVIDED AS PER DETAIL ABOVE.
4. SIZE AND THICKNESS OF CASING WALL SHALL BE AS SHOWN IN SCHEDULE.
5. ENDS OF BORE HOLE SHALL BE SEALED TO PREVENT ENTRANCE OF FILL MATERIAL AS REQUIRED.
6. A JOINT SHALL BE INSTALLED AT END OF CASING PIPE (SEE DETAIL).
7. CASING OF A LARGER SIZE THAN SHOWN IN THE ABOVE SCHEDULE OR CASING FOR PIPE LARGER THAN 18" SHALL BE APPROVED BY THE CITY ENGINEER.

NO.	REVISED	BY	CASING REQUIREMENTS FOR JACKING OR BORING	APPROVED BY:
				 DIRECTOR OF PUBLIC WORKS
DRAWN BY: J. KOESTER				
CHECKED BY: J. PODESTA				
SCALE: NONE			CITY OF MANTECA DEPARTMENT OF PUBLIC WORKS	DRAWING NO. U-9 DATE: JAN. 1988

At locations shown on the plans, or as specified by the Engineer, all utility crossings shall be bored and jacked into place. Jetting will not be allowed, and areas caving in adjacent to the boring tunnel shall be backfilled with sand or mortar.

The diameter of the bored hole shall not be more than 0.1 foot larger than the outside diameter of the pipe.

MORATORIUM

Trenching of City streets will not be permitted for a period of four (4) years after the placement of a new asphalt-concrete surface. For those streets with newly placed slurry seal coatings, the moratorium shall be two (2) years from the date of resurfacing. Exceptions to the above conditions are as follows:

1. Emergency which endangers life or property.
2. Work that is mandated by City, State, or Federal legislation.
3. Other situations deemed by the City Engineer to be in the best interest of the general public.

Should one or more of the above conditions exist such that trenching of the street is authorized, the following mitigation measures will apply:

ARTERIAL AND COLLECTOR STREETS

- A) Longitudinal Trenches Within Traveled Lane:
Over the City's standard trench restoration requirements, the entire traveled lane (limits to be determined by the Engineer) shall be edge planed and overlayed with one and one-half inches (1½") of asphalt-concrete or overlayed and tapered to conform with existing cross slope.
- B) Transverse Trenches Across Traveled Lanes:
Over the City's standard trench restoration requirements, an area no less than ten feet (10') wide on each side of the trench shall be planed and overlayed with one and one-half inches (1½") of asphalt-concrete or overlayed and tapered to conform with existing cross slope.

LOCAL SERVICE STREETS

- A) Resurfacing Age Under Four (4) Years Old:
Over the City's standard trench restoration requirements, the entire traveled lane (limits to be determined by the Engineer) for longitudinal trenches and ten feet (10') each side of transverse trenches shall be slurry sealed.
- B) Resurfacing Age Over Four (4) Years Old:
No additional resurfacing is required over the City's standard trench restoration requirements.

NO.	REVISED	BY	BORING AND TRENCHING OF CITY STREETS	APPROVED BY:  DIRECTOR OF PUBLIC WORKS
1	2/91	JB		
DRAWN BY: J. KOESTER			CITY OF MANTECA DEPARTMENT OF PUBLIC WORKS	DRAWING NO. U-10
CHECKED BY: J. BOND				DATE: OCT. 1990
SCALE: NONE				

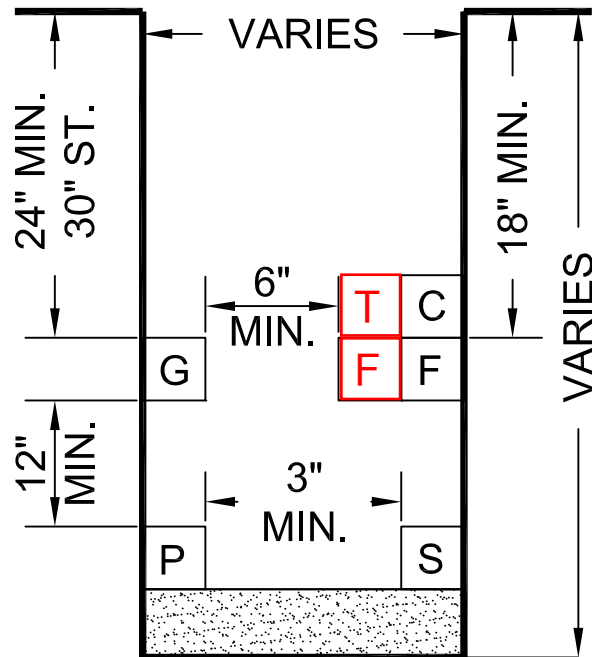

TYPICAL SECTION

- | | |
|---|---|
| G GAS | T TELE |
| P ELECT. PRI. | C CATV |
| S ELECT. SEC. | F FIBER OPTIC |

NO.	REVISED	BY	LOCATION OF DRY UTILITIES	APPROVED BY:
			CITY OF MANTECA DEPARTMENT OF PUBLIC WORKS	
DRAWN BY:				CITY ENGINEER
CHECKED BY:				DRAWING NO. U-11
SCALE: NONE				DATE: SEP. 2019