



Liquor City Expansion of Alcoholic Beverage Sales

1150 & 1152 W. Yosemite Avenue

Conditional Use Permit

November 21, 2024

City of Manteca Planning Commission Public Hearing

Site Location



GENERAL PLAN LAND USE

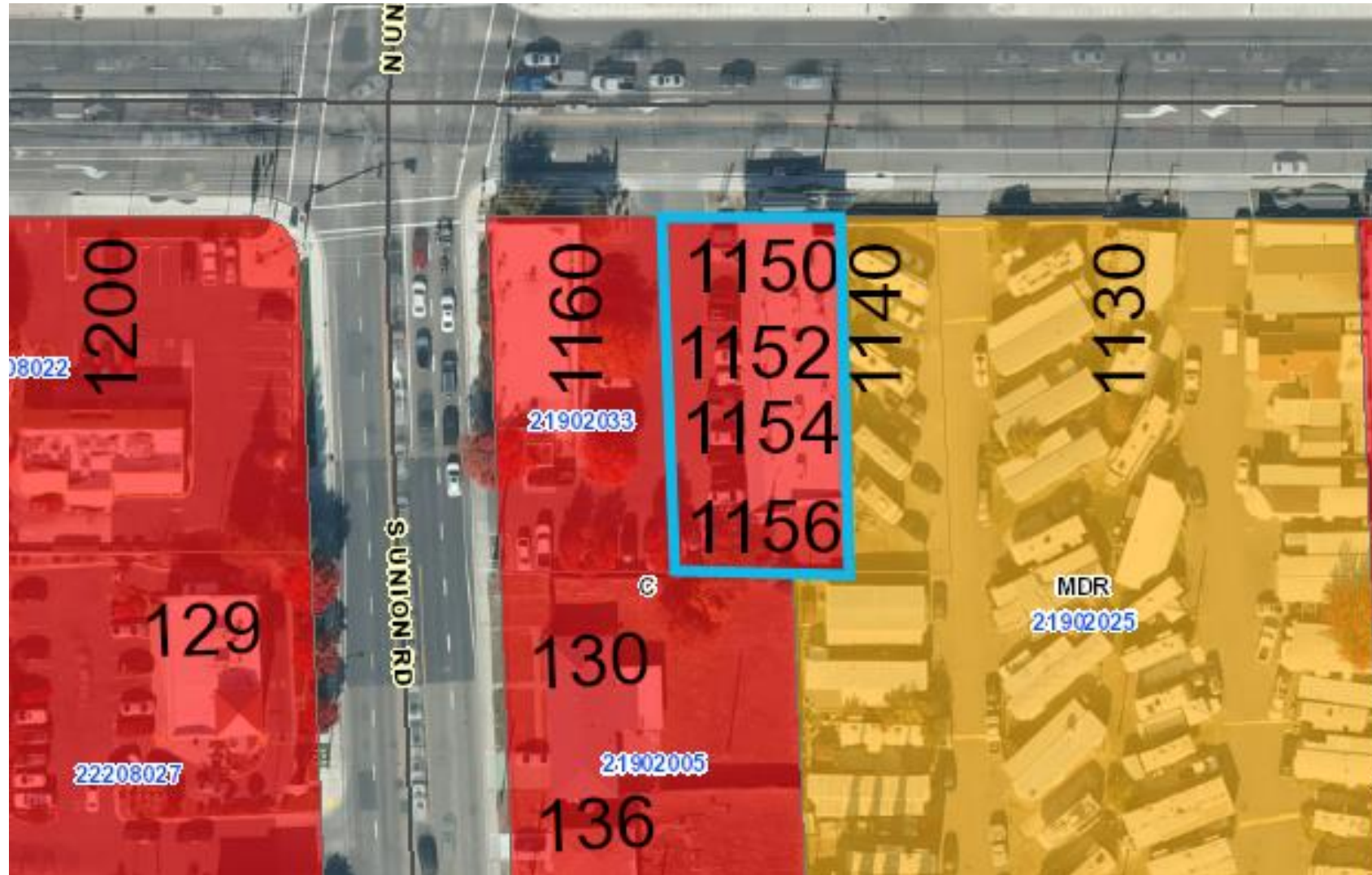

Zoning

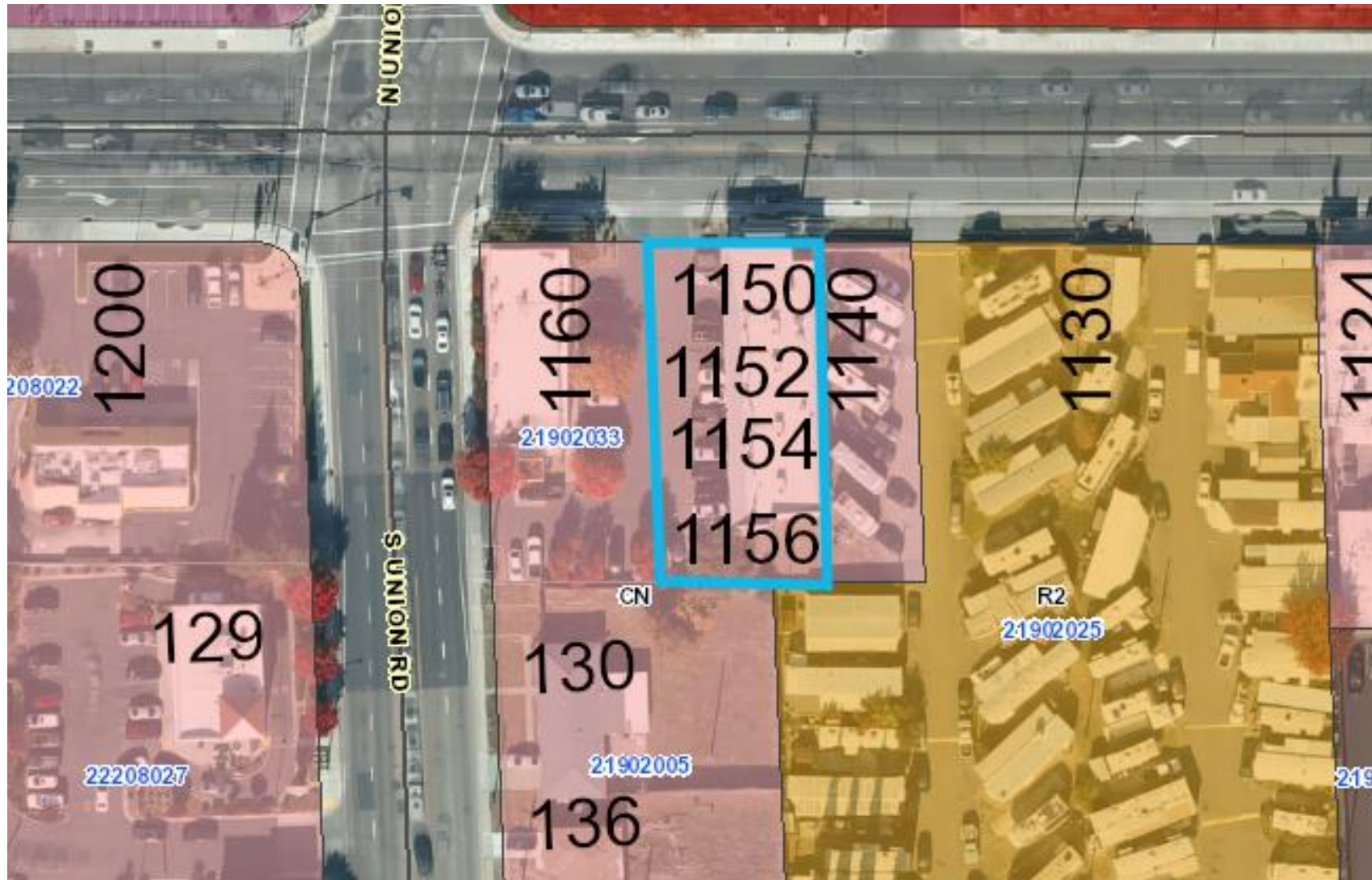

LANDSCAPING

PLANTING LEGEND		
SYMBOL	WATER USE	CITY
TREES		
	EXISTING TREES TO REMAIN	
SHRUBS / GROUNDCOVER		
	EXISTING SHRUBS TO REMAIN	
	TURF SOG	MODERATE ~ 800 SF

PLANTING PLAN GENERAL NOTES:

1. ALL PLANTS AND SPECIAL MATERIALS TO BE APPROVED BY OWNER PRIOR TO INSTALLATION.
2. ALL QUANTITIES TO BE VERIFIED IN FIELD.



IRRIGATION SCHEDULE		
SYMBOL	DESCRIPTION	QUANTITY
■	WHAFF CONTROLLER	1 (shown)
—	IRRIGATION CONTROL VALVE	1 (shown)
*	POP UP SPRINKLER	1 (shown)

IRRIGATION PLAN GENERAL NOTES:

1. ALL EQUIPMENT TO BE INSTALLED TO BE PROTECTED IN PLACE.

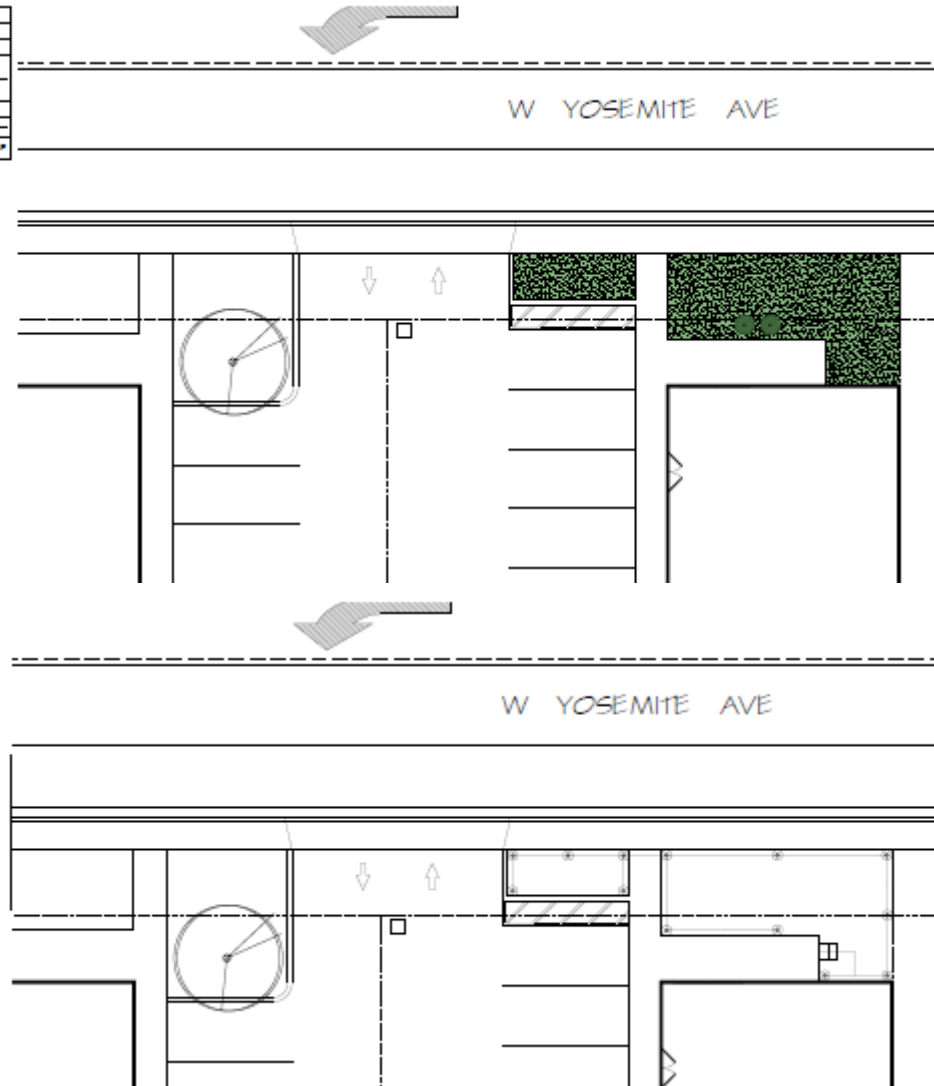

SUMMARY

- Consistent with General Plan and Zoning
- Meets required Conditional Use Permit findings
- Consistent with Climate Action Plan
- Exempt from CEQA - Section 15301, *Existing Facilities*



RECOMMENDATION

Motion to find:

- The project exempt from CEQA pursuant to Section 15301 and;

Adopt the following:

- Resolution approving a Conditional Use Permit allowing for the expansion of alcoholic beverage sales for Liquor City at 1150 & 1152 W. Yosemite Ave.





Thank you

November 21, 2024
City of Manteca Planning Commission Public Hearing